

# Salina 48

The Salina 48 has been designed to the most demanding list of specifications by architects Berret/Racoupeau. An extremely capable offshore catamaran, the Salina 48 is ideally suited to blue water cruising with an emphasis on stability, comfort, safety and spaciousness with all living areas on one level.

Its length (48'/14.30m) gives it a slender shape with a very low centre of gravity for optimal comfort and safety at sea while its 136m<sup>2</sup> sail plan performs very effectively without any pitch in more choppy conditions.

With a clean and obstacle-free deck, the Salina 48 affords easy movement and safe handling with an integrated saloon and cockpit that has generous entry access.

There is ample room at the revolutionary raised helm station to accommodate three people and all manoeuvring is conveniently controlled from this one central location. This steering position can be accessed via the cockpit or from the mastfoot, allowing for fluid and convenient movement around the deck.

The exterior design has been carefully considered so all fixtures are placed for maximum efficiency, performance, safety and space.

The Salina 48 has been manufactured with new technology including an infused sandwich composite hull plus a deckhouse moulded with new RTM eco-technology.



A decadent sunbathing deck at the aft of the Salina 48 enjoys exceptional protection from the elements while underway and provides yet another idyllic setting for relaxation.

Impressive cruising speeds can be achieved courtesy of the catamaran's good waterline length, generous sail plan and sleek design, and offshore passages are comfortable and enjoyable for sailors and non-sailors alike!

The catamaran is ideal for convivial entertaining with its social areas comprising a card table facing the sea, an L-shaped galley featuring a revolutionary new 'piano' refrigeration system, an indoor and outdoor dining table plus exterior corner lounge.

Each of the cabins boast magnificent sea views from the spacious portholes while the low beds, private bathrooms with separate showers and passageways without thresholds enhance the vessel's appeal.

The Salina 48 is available in two versions; The Standard version comprises four cabins and four bathrooms while the Owner's version has a private owner's suite separate to the guest accommodation.





# Salina 48

Specifications	
LOA	14.30 m / 47.01 ft
Beam	7.70 m / 25.25 ft
Draft	1.10 m / 3.60 ft
Air Draft	21 m / 68.90 ft
Displacement	10.5 tonne
Sail Area Genoa	54 m <sup>2</sup> / 581 sq ft
Sail Area Mainsail	78 m <sup>2</sup> / 840 sq ft
Engines – larger optional	2 x 40 hp
Freshwater Capacity – larger optional	1 x 750 litre
Diesel Capacity – larger optional	1 x 480 litre
Architects and Designer	Berret - Racoupeau
Layout Options	Standard – 4 doubles / 4 bathrooms Owner's – 3 doubles / 3 bathrooms

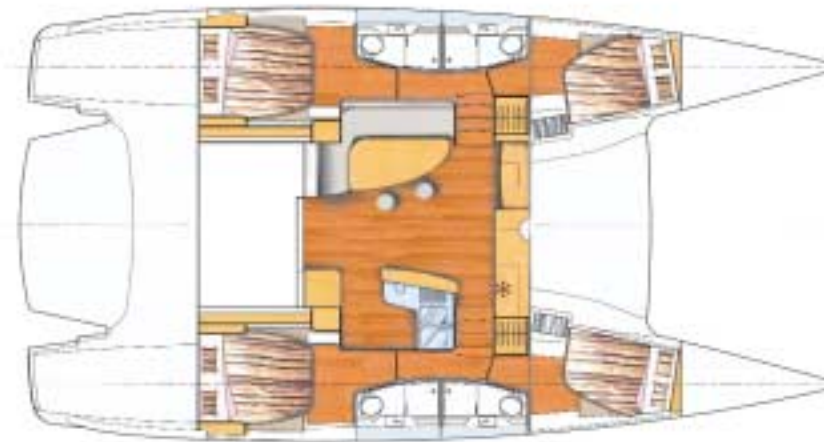

Standard Version



Owner's Version